

Surveyed for: **Keefe Real Estate, Inc.**
416 Bauer Parkway
Delavan, Wisconsin. 53115

of

A parcel of land described in Title Commitment No. WA-19886 prepared by Chicago Title Insurance Company, dated July 13, 2021 as shown below

Parcel A:
Begin at an iron pipe North 66° 25' East 100.0 feet of an iron pipe at the Southwest corner of Plat of Mereness Springs, a duly recorded Subdivision for Walworth County, thence South 31° 44' East 50.1 feet to a point, thence South 66° 25' West 44.8 feet to an iron pipe and place of beginning, thence South 66° 25' West 82.6 feet to an iron pipe, thence South 25° 35' East 82.75 feet to an iron pipe, thence North 77° 15' East 100.0 feet to an iron pipe, thence North 32° 13' West 105.4 feet to a place of beginning. All of above mentioned property being in the Southwest 1/4 of the Southeast 1/4 of Section 22, Township 2 North, Range 16, of the Fourth Principal Meridian, Walworth Walworth County, Wisconsin.

Tax Key No.: F D 2200059
Address: 1718 South Shore Drive

Parcel B:
Commencing on the East line of Block 2 of the plat of San Souci located in Section 22, Township 2 North, Range 16 East at a point 82.50 feet South of the Northeast corner of Block 2, thence South 7° 15' East 60 feet; thence North 82° East 262.30 feet; thence South 35° 45' West 178.60 feet; thence South 50 feet; thence Northwesterly 169 feet to the Southeast corner of Block 2 plat of San Souci; thence North along the East line of Block 2 plat of San Souci to the place of beginning.

Tax Key No.: F D 2200056

Parcel C:
Beginning at a state North 88° 45' East and distant 2 chains and 30 links from a stake 60 1/2 links between the Northeast corner of the Plat of Point Comfort on the Southeast fractional 1/4 of Section 22, Township 2 North, Range 16 East and being at the Southeast corner of lands heretofore conveyed by George W. Mereness and Anna E. Mereness, thence South 1/2 mile to William N. Mereness, Jr., and thence dated September 18, 1890, and running thence North 66° 25' East 1 chain and 51 1/2 links to a stake, thence North 31° 44' West 4 chains and 95 links more or less to the shore of Delavan Lake, thence Southwesterly along the shore of said lake 1 chain 51 1/2 links to the East line of land formerly owned by William N. Mereness, thence South 31° 44' East along said Mereness' former East line 4 chains and 95 links more or less to the place of beginning. A beginning at the Southeast corner of the plat of land owned by the State of Wisconsin, thence North 79° 57' East 1/2 mile to the Southeast corner of the plat of land owned by Walworth County, Wisconsin, and running thence North along the East line of said plat of San Souci 82 1/2 feet, thence North 79° 57' East 75 feet; thence North 25° 35' East 62 7/8 feet to an iron stake and continuing in same course to a point which is 42.6 feet North 66° 25' East of the place of beginning, thence North 66° 25' West 62 7/8 feet to the place of beginning, all of which is the same property as mentioned property being in the Southwest 1/4 of the Southeast 1/4 of Section 22, Township 2 North, Range 16 East, Walworth County, Wisconsin.

Tax Key No : F 0 2200058

Parcel D:
Lots 6 and 7 on the Plat of Mereness Springs situated on the South 1/2 of Section 22, Township 2 North, Range 16 East, according to the plat thereon on record in the Office of the Register of Deed in and for the County of Walworth, State of Wisconsin.

Tax Key No.: FMS 00006

Parcel E:
Lot 2, Certified Survey No. 2229 as recorded in Volume 10 of Certified Surveys on Page 357, recorded in the office of the Register of Deeds in and for Walworth County, Wisconsin, located in the Southwest 1/4 of the Southeast 1/4 of Section 22, Township 2 North, Range 16, East of the Fourth Principal Meridian.

Tax Key No.: FA222900002
Address: 1720 South Shore Drive

Parcel F:
Lot 1, Certified Survey No. 2229

Tax Key No.: FA222900001
Address: 1800 South Shore Drive

Point recorded as being
N66°25'E of the Southeast
Corner of Lot 1 in the
plat of Mereness Springs

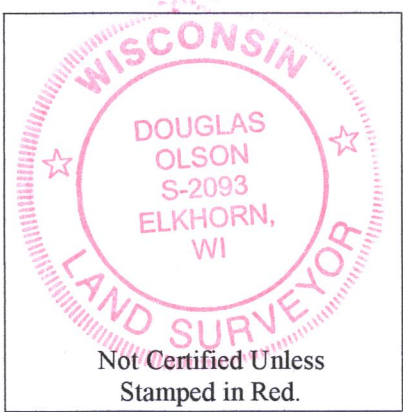

Notes:

- 1) This Plat of Survey is not certified unless signed and sealed in red ink.
- 2) This survey is subject to Wisconsin lien laws. This Plat of Survey is the notice of intent to file lien. Lien waiver required.
- 3) The Survey Date shown on this Plat of Survey is the completion date of the field work.

Copyright© 2017 by Olson Land Surveying, LLC.

All rights reserved. No part of this survey plat may be reproduced or transmitted in any form by any means - graphic, electronic, or mechanical, including photocopying, tracing, or information storage and retrieval systems - without permission in writing from Douglas G. Olson, Olson Land Surveying, LLC.

I hereby certify that I have surveyed the above described property in compliance with Chapter A-E 7 of the Wisconsin Administrative Code and that the map hereon is correct to the best of my professional knowledge and belief and shows the size and location of the property, its exterior boundaries, the location and dimensions of all visible structures thereon, boundary fences, apparent easements and roadways and visible encroachments, if any.

This survey is made for the exclusive use of the present owners of the property and also those who purchase, mortgage or guarantee title thereto, within one year of the date hereof.

Douglas G. Olson
Wisconsin Professional Land Surveyor - 2093

RECEIVED
OCT 13 2021
By *SMR*

Southeast Corner
 Section 22-2-16
 N. 226,233.36
 E. 2382,234.68

2021.082

Sheet 1 of 7 Sheets

Name: _____

Job Reference Number

2021 082

Legend of Symbols & Abbreviations

- Found County Section Corner
 Found Concrete Monument
 Found Iron Pipe Found RR Spike
 Found Iron Rod
 Set Iron Pipe, 1" dia. Set Mag Nail
 Recorded Information
 Utility Pole Lamp
 Utility Pedestal Gas Valve
 Manhole
 BOLLARD
 Asphalt Surface
 Concrete Surface
 Bright Beacon

N North
S South
E East
W West
in Bearings
Degrees
Minutes
Seconds
in Distances
Feet
Inches
No. Number
NW. Northwest
NE. Northeast
Dia. Diameter



OLSON
LAND SURVEYING, LLC

Rural | Residential | Commercial

45 South Wisconsin Street | P.O. Box 322
Elkhorn, Wisconsin. 53121
Telephone: (262) 723-3434
Facsimile: (262) 723-8044
Email: doug@olsonsurveying.com
Website: www.olsonsurveying.com

Scale in Feet

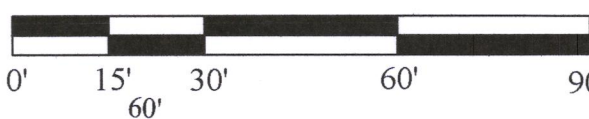
$$1'' = 30$$

Survey date: July 30, 2021.

Revisions: No. 1 - Bearings Rotated

FD 22-59 FD22-56 FD22-58 FM5-6 FA2229-2 FA2229-1

216-5844